

ALUMINIUM CONCEALED BUTT HINGE

Code No. A 142

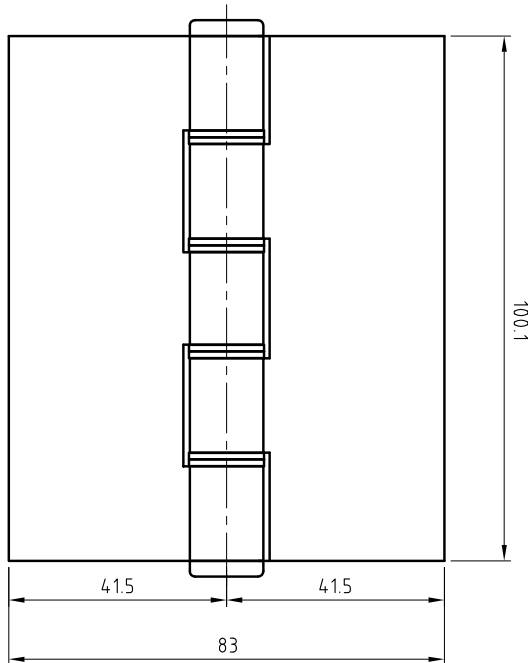

APPLICATION

- Suitable for Aluminium doors in medium usage situations.

SPECIFICATION

- **Alloy:** High strength T.6 minimum tensile 254 mpa.
- **Pin Dia:** 4.7mm 304 Stainless Steel with machined chamfer both ends.
- **Bushes:** Flanged nylon.
- **Knuckle:** Round
- **Aluminium Endcaps:** Pressed-in interference fit.
- **Maximum Weight Capacity:** 20 kg (turn over for further information)

INSTALLATION GUIDE ONLY

- **Door thickness: Minimum 35mm.**
- When using a door closer, we recommend a minimum of 3 hinges be used, with the top hinge located as high as possible. For excessive usage, a fourth hinge may be required.
- Standard Door: 2040 (h) x 820 (W)

FIXING

- **Fastening screws not supplied.**
- Concealed fix.
- Pop rivets are not recommended.

FINISH

- Satin Natural Anodised only.

OLD CODE NO.

- AB 45

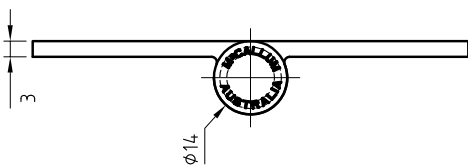

Code No. A 142

